

P1 CONFIG.

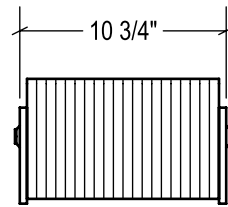

P2 CONFIG.

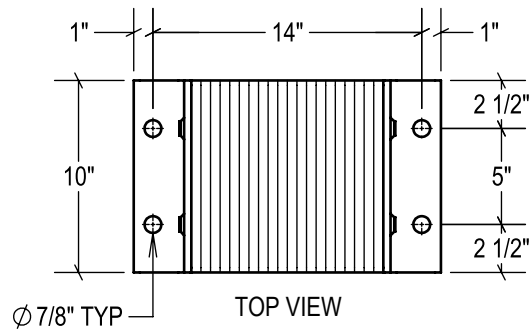

TOP VIEW

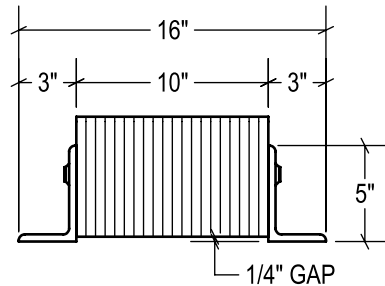

FRONT VIEW

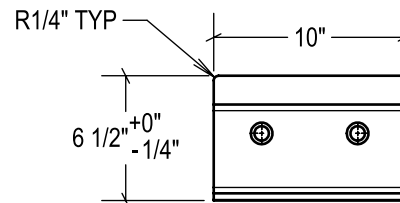

SIDE VIEW

STANDARD
model #: LB610-14
part #: 24-2060
Bolted (2) Sides

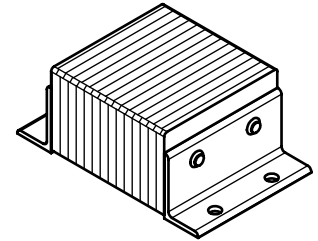

P1 CONFIG.
model #: LB610-14/P1
part #: 24-2061
Welded (1) Side

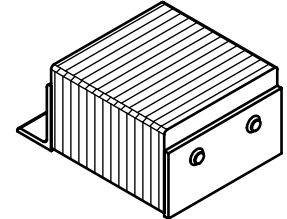

P2 CONFIG.
model #: LB610-14/P2
part #: 24-2062
Welded (2) Sides

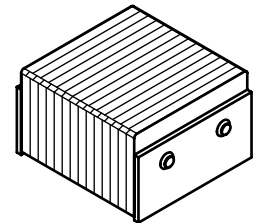

ESTIMATED GROSS SHIPPING WEIGHT = 44 LBS

SPECIFICATIONS:
FURNISH AND INSTALL LAMINATED RUBBER DOCK BUMPERS AS PROVIDED BY METRO DOCK. LAMINATED PADS SHALL BE MADE FROM REINFORCED TRUCK TIRES CUT TO 6.125" x 10" PUNCHED AND ASSEMBLED THROUGH 3/4" RODS BETWEEN 3" x 5" x 3/8" STRUCTURAL STEEL UNDER 1, 500LBS OF PRESSURE. FINISH OF EXPOSED METAL SHALL BE PAINTED WITH WATER-BASED AND LEAD-FREE PAINT OR HOT-DIPPED GALVANIZED (OPTIONAL).

ALL DIMENSIONS ARE $\pm 1/8"$ UNLESS SPECIFIED OTHERWISE

DRAWN BY:
T.CHUNG

DATE:
2018-12-12

CHECKED BY:

DATE:

THE INFORMATION CONTAINED IN THIS DRAWING IS THE SOLE PROPERTY OF METRO DOCK ANY REPRODUCTION IN PART OR AS A WHOLE IS PROHIBITED.



3rd Angle

SIZE:
A

metroDock

DESCRIPTION:

LAMINATED RUBBER BUMPER LB610-14

SCALE:
1:10

SHEETS:
1 of 1

DRAWING NUMBER:
MKT_LB610-14

REV:
1